

CALCUTTA TE 50GT ⁰¹

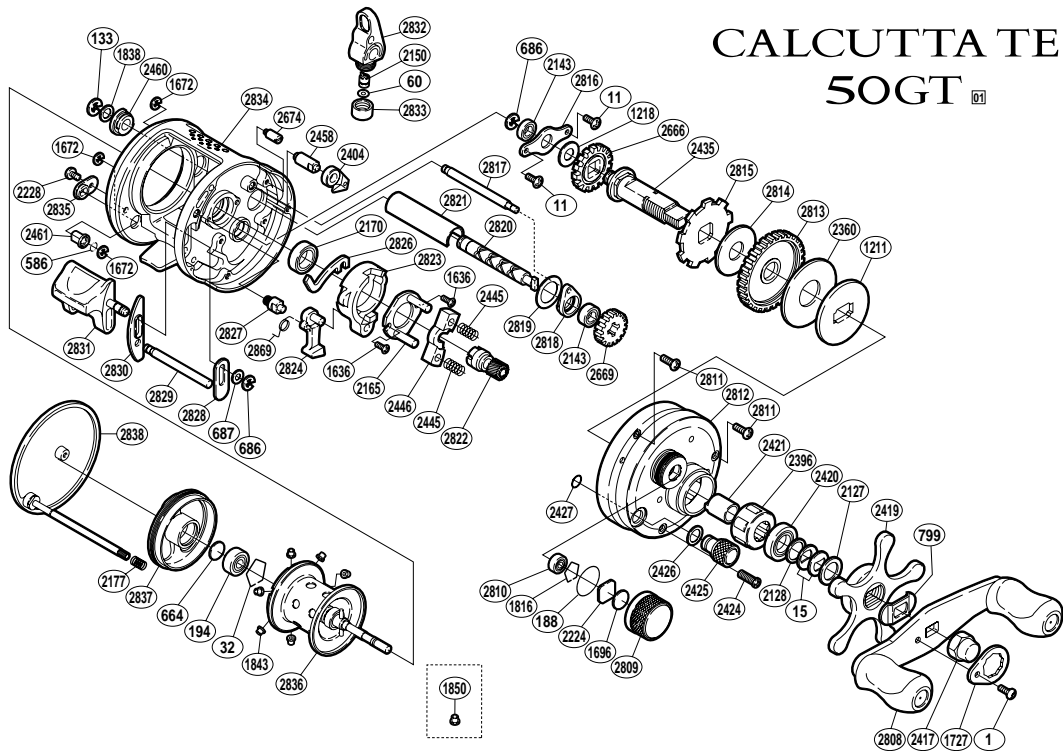

BNT No.	PARTS NAMES	BNT No.	PARTS NAMES	BNT No.	PARTS NAMES
0001	Handle Nut Plate Screw	2177	Left Side Plate Spring	2813	Drive Gear
0011	Drive Shaft Retainer Screw	2224	Spool Tension Spacer (A)	2814	Drag Washer (A)
0015	Drag Spring Washer	2228	Damper Guide Screw	2815	Anti-Reverse Ratchet
0032	Bearing Retainer (B)	2360	Drag Washer (C)	2816	Drive Shaft Retainer
0060	Spacer	2396	Roller Clutch Bearing	2817	Level Wind Guide
0133	Worm Shaft Retainer	2404	Anti-Reverse Pawl	2818	Worm Bushing (A)
0188	"O" Ring	2417	Handle Nut	2819	Worm Spacer
0194	Ball Bearing	2419	Star Drag	2820	Worm Shaft
0586	Bolt Retainer	2420	Star Drag Bearing	2821	Level Wind Guard
0664	Spacer (B)	2421	Roller Clutch Inner Tube	2822	Pinion Gear (A)
0686	"E" Lock	2424	Right Side Plate Screw (long)	2823	Clutch Cam
0687	Spacer	2425	Side Plate Open Nut	2824	Clutch Pawl
0799	Friction Washer	2426	Open Nut Washer	2826	Clutch Plate
1211	Key Washer	2427	"O" Ring	2827	Set Pin
1218	Idle Gear (A) Spacer	2435	Drive Shaft	2828	Clutch Bar Guide (A)
1636	Clutch Cam Screw	2445	Yoke Spring	2829	Clutch Bar Support
1672	"E" Lock	2446	Yoke	2830	Clutch Bar Guide (B)
1696	Cast Control Spacer (B)	2458	Anti-Reverse Pawl Pin	2831	Quick-Fire II Clutch Bar
1727	Handle Nut Plate	2460	Worm Bushing (B)	2832	Line Guide
1816	Bearing Retainer (A)	2461	Damper (A)	2833	Pawl Cap
1838	Worm Shaft Washer (B)	2666	Idle Gear (A)	2834	One-Piece Frame
1843	Brake Collar (blue)	2669	Idle Gear (C)	2835	Damper Guide
2127	Star Drag Spacer	2674	Pawl Stop	2836	Spool Assembly
2128	Bearing Washer	2808	Handle Assembly	2837	Brake Case
2143	Ball Bearing	2809	Cast Control Cap	2838	Left Side Plate
2150	Line Guide Pawl	2810	Ball Bearing	2869	Clutch Pawl Spring
2165	Clutch Cam Retainer	2811	Right Side Plate Screw (short)		
2170	Ball Bearing	2812	Right Side Plate	1850	Brake Collar (Yellow)